

CYCLONE SECONDARY SHUTOFF

PART#	DESCRIPTION	L x W	WEIGHT
1008-0700	12 GALLON CYCLONE WITH 3" OPENINGS, (500 CFM)	43 1/2 x 18 1/4	95 LBS
1008-0704	12 GALLON CYCLONE WITH 4" OPENINGS, (800 CFM)	43 1/2 x 18 1/4	97 LBS
1008-0720	12 GALLON CYCLONE WITH 6" OPENINGS, (1500 CFM)	43 1/2 x 18 1/4	99 LBS



AVAILABLE NOW!

**NO
SECONDARY
BYPASS**

- From 500-1500 CFM
- 12 Gallon Capacity
- Secondary Moisture Trap
- All Welded Steel Construction

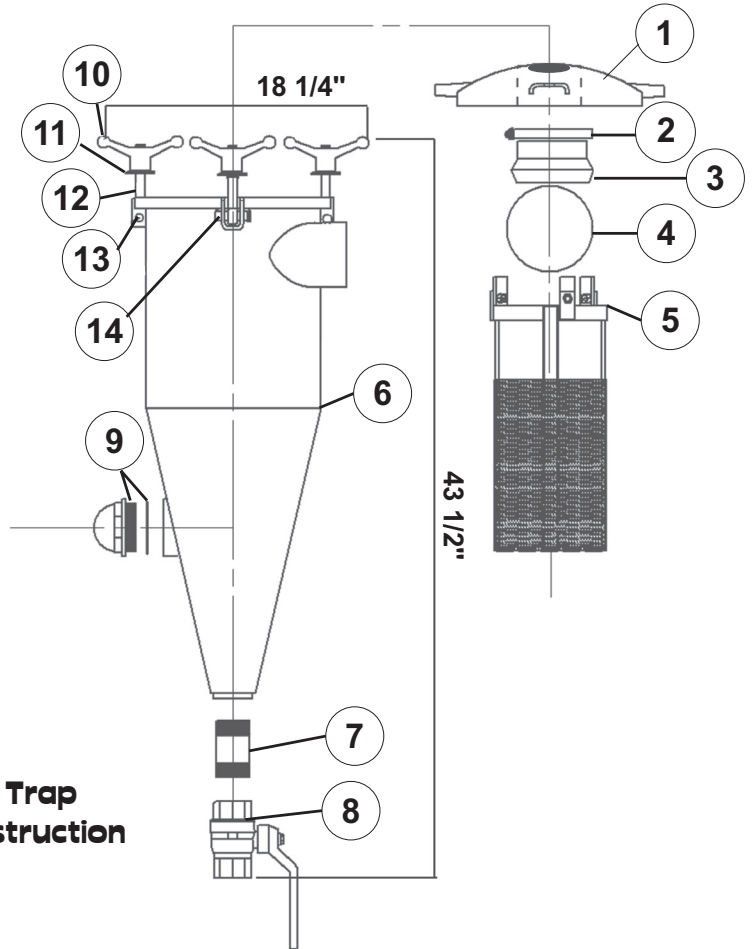

POS.	PART#	DESCRIPTION	REQ.
REPLACEMENT PARTS			
1	1014-2113	12" Primary Lid Weldment 3"	1
	1014-2114	12" Primary Lid Weldment 4"	1
2	1090-0001	Hose Clamp (3" Size Rub Seat)	1
	1089-0002	Hose Clamp (4" Size Rub Seat)	1
3	1090-0000	3" Rub. Seat For 3" Sch. 40 Pipe	1
	1089-0001	4" Rub. Seat For 4" Sch. 40 Pipe	1
4	1076-0000	6" Stainless Steel Float Ball	1
5	1014-0070	8" Perf. Ball Cage w/ Tabs	1
6	1008-0712	Lwr. Half Cyc. sec. Weldment 3"	1

POS.	PART#	DESCRIPTION	REQ.
REPLACEMENT PARTS			
6	1008-0713	Lwr. Half Cyc. sec. Weldment 4"	1
7	1053-0002	2" x 4" NPT Close Nipple	3
8	1042-0000	2" Ball Valve	3
9	1093-0003	3" Glass & O' Ring	3
10	1010-0001	5/8" Wing Nut	3
11	1010-0003	Zinc Manway Washer	3
12	1021-0000-B	5/8" x 5" Eyebolt	1
13	1021-0000-P	Clevis Pin	1
14	1021-0000-R	Roll Pin	1