

# 4 BOLT FLANGE X FLANGE BRASS PISTON VALVES

## WITH STAINLESS STEEL GATE & TEFLON SEATS (HELPS PREVENT LEAKING)

4 BOLT FLANGE X FLANGE



PART#	DESCRIPTION	WEIGHT
2104-0000 MZ	4" 4 Bolt Flange Valve with Stainless Steel Disc - (60 PSI)	15 lbs
2104-1000 MZ	4" 4 Bolt Flange Valve with Stainless Steel Disc with Air Cylinder	22 lbs
2104-1001 MZ	4" 4 Bolt Flange Valve with Stainless Steel Disc with Hydraulic Cyl	22 lbs
2106-0000 MZ	6" 4 Bolt Flange Valve with Stainless Steel Disc - (60 PSI)	23 lbs
2106-1000 MZ	6" 4 Bolt Flange Valve with Stainless Steel Disc with Air Cylinder	31 lbs
2106-1001 MZ	6" 4 Bolt Flange Valve with Stainless Steel Disc with Hydraulic Cyl	31 lbs
2108-0000 MZ	8" 4 Bolt Flange Valve with Stainless Steel Disc	35
-	4-BOLT FLANGE PLATE WITH 4" HOLE	3 lbs
-	4-BOLT FLANGE PLATE WITH 6" HOLE	3 lbs



- AVAILABLE WITH OR W/O DOUBLE ACTION AIR CYLINDER
- 4", 6" OR 8" PISTON VALVE W/S.S. DISC & SEALS
- DURABLE BRASS & S.S. CONSTRUCTION
- 4 BOLT FLANGE X FLANGE FITTINGS
- AVAILABLE IN 4", 6" OR 8" SIZE
- 60 PSI RATING



#	MZ PART#	DESCRIPTION
	4" VALVE	
1	2104-0001 MZ	BODY
2	2104-0002 MZ	SEAT RING
3	2104-0003 MZ	SLEEVE
4	2104-0004 MZ	O-RING (2)
5	2104-0005 MZ	O-RING
6	2104-0006 MZ	O-RING
7	2104-0007 MZ	S.S. GATE
8	2106-0008 MZ	SCREW
9	2106-0009 MZ	CLAMP (2)
10	2104-0010 MZ	GASKET

#	MZ PART#	DESCRIPTION
	4" VALVE	
11	1045-0004 MZ	STEM
12	2104-0012 MZ	HEAD
13	1040-0004 MZ	2-STEM GASKET
14	1046-0008 MZ	NUT
15	1046-0009 MZ	FORK
16	1046-0006 MZ	SCREW
17	2106-0018 MZ	LOCKNUT

#	MZ PART#	DESCRIPTION
	6" VALVE	
1	2106-0001 MZ	BODY
2	2106-0002 MZ	SEAT RING
3	2106-0003 MZ	SLEEVE
4	2106-0004 MZ	O-RING
5	2106-0005 MZ	O-RING
6	2106-0006 MZ	O-RING
7	2106-0007 MZ	S.S. GATE
8	2106-0008 MZ	SCREW
9	2106-0009 MZ	CLAMP (2)
10	2106-0010 MZ	GASKET

#	MZ PART#	DESCRIPTION
	6" VALVE	
11	1046-0004 MZ	STEM
12	2106-0012 MZ	HEAD
13	1040-0004 MZ	2-STEM GASKET
14	1046-0008 MZ	NUT
15	1046-0009 MZ	FORK
16	1046-0006 MZ	SCREW
17	2106-0018 MZ	LOCKNUT

#	MZ PART#	DESCRIPTION
	8" VALVE	
1	2108-0001 MZ	BODY
2	2108-0002 MZ	SEAT RING
3	2108-0003 MZ	SLEEVE
4	2108-0004 MZ	O-RING
5	2108-0005 MZ	O-RING
6	2108-0006 MZ	O-RING
7	2108-0007 MZ	S.S. GATE
8	2108-0008 MZ	SCREW
9	2108-0009 MZ	CLAMP (2)
10	2108-0010 MZ	GASKET

#	MZ PART#	DESCRIPTION
	8" VALVE	
11	1047-0004 MZ	STEM
12	2108-0012 MZ	HEAD
13	1047-0007 MZ	2-STEM GASKET
14	10460-0008 MZ	NUT
15	1046-0009 MZ	FORK
16	1046-0006 MZ	SCREW
17	2108-0018 MZ	LOCKNUT

DIMENSIONS		
0"	4"	6"
A	3.5"	4.5"
B	1.8"	2.4"
C	3.2"	4.2"
D	3.7"	5.7"
d	0.0"	0.0"
F	0.4"	0.4"
H	11.7"	17.3"
h	9.8"	14.9"
I	4.7"	5.9"
L	2.7"	2.7"

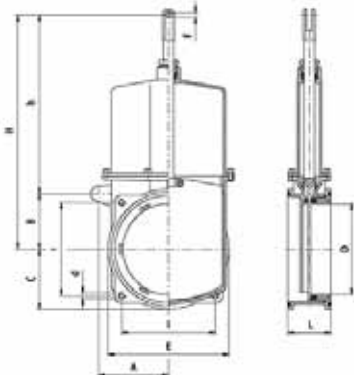

[www.chandlerequipment.com](http://www.chandlerequipment.com)

Due to unforeseeable market fluctuations, prices are subject to change without notice.

