

SIGHT EYES

- STEEL, ALUMINUM, OR STAINLESS STEEL DESIGN
- EXTRA THICK WELDABLE BASE
- REMOVEABLE GLASS OR PLASTIC LENS
- O-RING STYLE SEAL



PART #	DESCRIPTION	WEIGHT
1093-0000	2" Plastic Sight Eye, Complete, 70 PSI	.5 lbs
1093-0001	3" Plastic Sight Eye, Complete, 70 PSI	1.25 lbs
1092-0000	5" Glass Sight Eye, Complete, Steel, 70 PSI	5 lbs
1092-0100	5" Glass Sight Eye, Complete, Aluminum, 70 PSI	2.5 lbs
1093-0008	2" 304 Stainless Steel Sight Eye, Complete, 70 PSI	.5 lbs
1093-0009	3" 304 Stainless Steel Sight Eye, Complete, 70 PSI	1.14 lbs
1092-0000 MZ	5" MZ Glass Sight Eye, Complete, Steel, DISCONTINUED	5 lbs
1094-0015	1.5" OD x 1" ID x 72" Length Acrylic Sight Tube	-
1094-0020	2" OD x 1.5" ID x 72" Length Acrylic Sight Tube	-

* Special price while inventory lasts. Glass bowl is interchangeable with standard 5" sight eyes.

SIGHT EYE REPLACEMENT PARTS

2" & 3" SIGHT EYES

PART #	DESCRIPTION
1093-0002	2" Glass & O-ring
1093-0003	3" Glass & O-ring
1093-0004	2" Weldment Base
1093-0005	3" Weldment Base
1093-0006	2" O-ring
1093-0007	3" O-ring

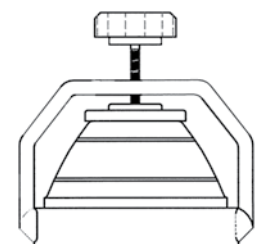
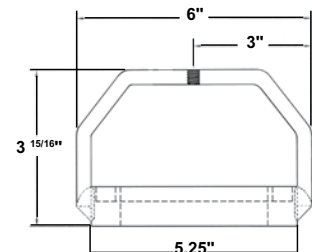
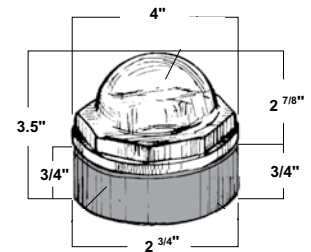

5" SIGHT EYES

PART #	DESCRIPTION
1092-0001-NS	New Style 5" Sight Eye Glass Bowl
1092-0002	5" Sight Eye Hand Wheel
1092-0003-NS	New Style 5" Sight Eye Plate
1092-0004	5" Sight Eye Steel Weldment
1092-0026	5" Sight Eye Aluminum Weldment
1083-0000	5" Sight Eye Gasket